

REV.	DESCRIPTION	DATE	DRAFTER	APPROVER
A1	DWG.REL	2020.6.02	ZHANG	JIN

- Material
  - ①Housing : PA66, UL94V-0
  - ②Pin header : Copper alloy, Tin plated
  - ③Nut : M2.5,Copper alloy

- Electrical
 

UL	IEC
Rated voltage : 300V	250V
Rated current : 8A	7A

- Mechanical
  - Operating temperature:  $-40^{\circ}\text{C} \sim +105^{\circ}\text{C}$
  - Soldering temperature:  $250^{\circ}\text{C} \pm 5/5\text{sec}$
  - Withstanding Voltage : AC1500V/1min

- RoHS compliance

HOW TO ORDER

KF2EDGVM-X-3.5-XXP-1 X-XXXXX

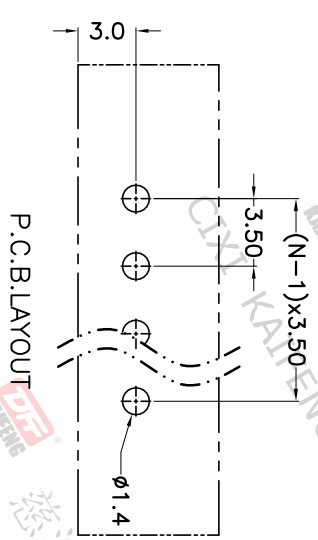
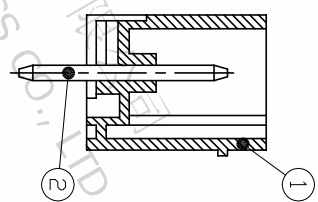
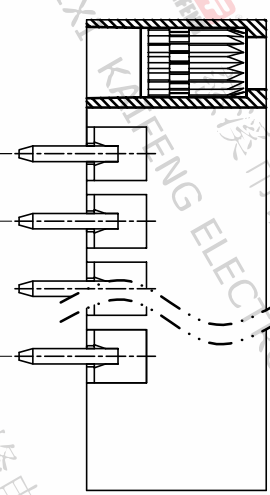
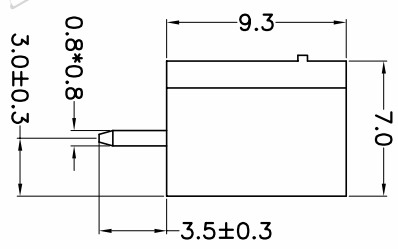
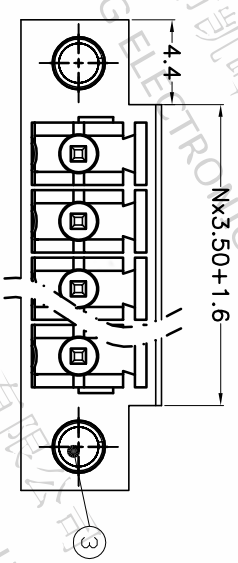
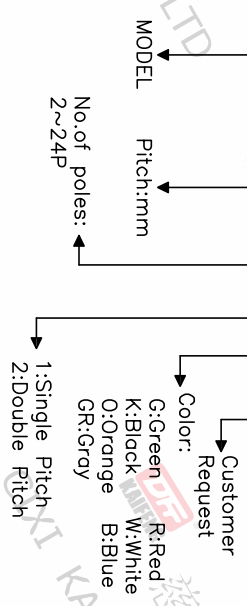

Pitch range	Nominal dimension range	PROJECTION
>0	>0	0.1/10
>6	>30	□
>10	>60	□
~	~	□
6	30	□
10	60	□
24	100	□
~	~	□
±0.15	±0.30	□
±0.20	±0.50	□
±0.30	±0.70	□
±0.50	±1.00	□
±1.00	±1.30	□
±2*	±2*	□

DRAWING TYPE	CUSTOMER DRAWING
SCALE	1:1
SHEET	1 OF 1
DRAWING NO.	W10000712

PROJECTION	TITLE
UNIT	KF2EDGVM-Y-3.5-XXP-1X
SHEET SIZE	A4
SERIES	KF2EDGVM-Y

**DF** 慈溪市凯峰电子有限公司  
 CIXI KAIFENG ELECTRONICS CO.,LTD

